

SM239 SENSOR REPLACEMENT INSTRUCTIONS

WARNING: **DISCONNECT POWER BEFORE SERVICING**
DESUNA LA ELECTRICIDAD ANTES DE HACER REPARACIONES

Service of a hand dryer should be performed by a licensed electrician.

1. After disconnecting power, remove the cover by loosening the two tamper-resistant screws with the security wrench provided with the dryer.
2. Carefully unplug the four electrical connectors that plug into the sensor and disconnect the two lead wires from the power supply. Make a note of which wire goes to which terminal.
3. Carefully remove the nozzle assembly from the blower housing by removing the four screws.
4. Remove the sensor from the backplate by removing the single mounting screw.
5. Install the new sensor by attaching to the backplate with the mounting screw, position sensor as high as possible. Reconnect the four electrical connectors and the power supply; replace the nozzle assembly and cover.
6. After checking the wiring, apply power and test. INCREASE sensitivity (FIGURE 2) by using a flat-blade screwdriver and CAREFULLY turning the adjustment pot located on the sensor CLOCKWISE 1/3 turn MAX. DECREASE sensitivity, turn COUNTERCLOCKWISE 1/3 turn MAX.
7. **Adjusting Sound & Speed** - The dryer is shipped set at maximum speed. Using a small flat blade screwdriver, CAREFULLY turn the SPEED pot COUNTERCLOCKWISE 3/4 TURN MAX to REDUCE SOUND & SPEED. CAREFULLY turn the pot CLOCKWISE to INCREASE SOUND & SPEED. See figure 2.
8. **Adjusting Sensitivity** - The sensor is adjusted at the factory to turn on when hands are 4-6 inches away from the bottom of the dryer. To INCREASE SENSITIVITY, turn the pot CLOCKWISE up to 1/3 TURN MAX. To DECREASE SENSITIVITY, turn the pot COUNTERCLOCKWISE up to 1/3 TURN MAX. See figure 3.
9. **Carefully** replace the cover using (2) tamper-proof screws supplied. Apply a bead of caulk around edges of cover to wall.



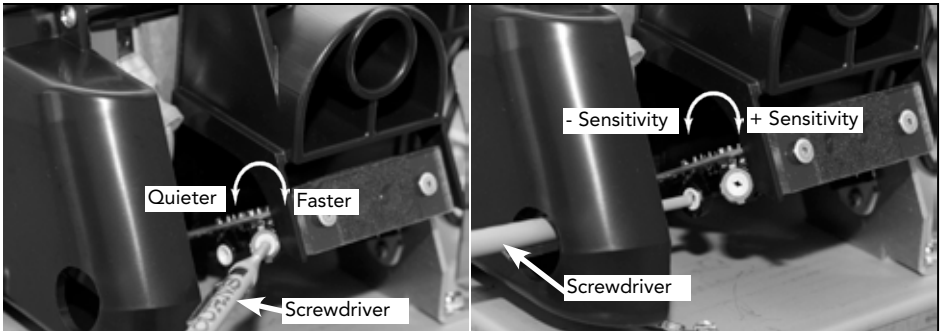
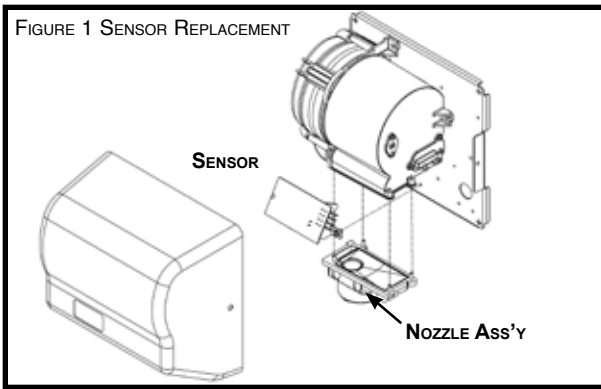

ADJUSTING SOUND & SPEED

The dryer is shipped set at maximum speed. Turn counterclockwise to reduce sound and speed. 3/4 of a turn max.

ADJUSTING SENSITIVITY

Place the screwdriver through the access hole as shown to adjust sensitivity. Range is set at the factory for 4 - 6 inches.

FIGURE 2 - ADJUSTING SPEED/SOUND AND SENSITIVITY

Distributed by
www.AmeraProducts.com
 Phone: (800) 608-6568
 Fax: (409) 840-5545
info@ameraproducts.com